

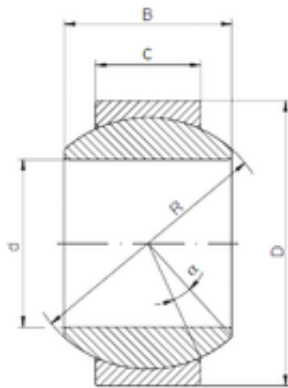

CYSD BEARING-ENGLAND CO.,LTD.

30 mm x 55 mm x 32 mm ISO GE 030 HS-2RS
plain bearings



Bearing No. GE 030 HS-2RS

Size	30x55x32 mm
Bore Diameter	30 mm
Outer Diameter	55 mm
Width	32 mm
d	30 mm
D	55 mm
B	32 mm
C	20 mm
R	47 mm
Angle	17 °

GE 030 HS-2RS Bearing 2D drawings and 3D CAD models